



House - Mid Terrace

13 STANHOPE
ROAD,
SWANSCOMBE,
DA10 0AN

Per Month

£1,395

FEATURES

- Two-bedroom terraced house
- Spacious living room
- Separate dining room
- Fitted kitchen
- Good transport links
- Close to local shops and amenities

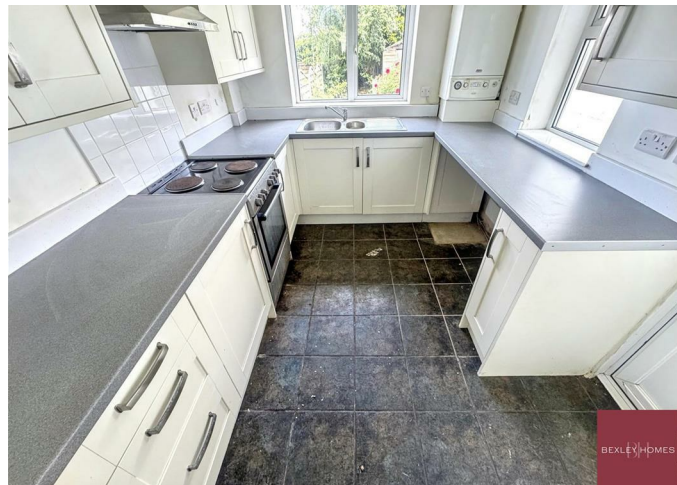

BEXLEY HOMES

2 Bedroom House – Mid Terrace located in Swanscombe

2 Bedroom House to Rent – Stanhope Road, Swanscombe, DA10 0AN

A well-presented two-bedroom family home located in the popular residential area of Swanscombe. This spacious property offers approximately 870 sq ft of internal living space across two floors, making it ideal for couples, small families, or working professionals.

The ground floor comprises a bright and spacious living room, separate dining room, and fitted kitchen with ample storage and worktop space. Upstairs features two good-sized bedrooms and a modern family bathroom.

The property further benefits from excellent natural light throughout, generous room sizes, and convenient access to local amenities, schools, and transport links including Swanscombe Station and Ebbsfleet International.

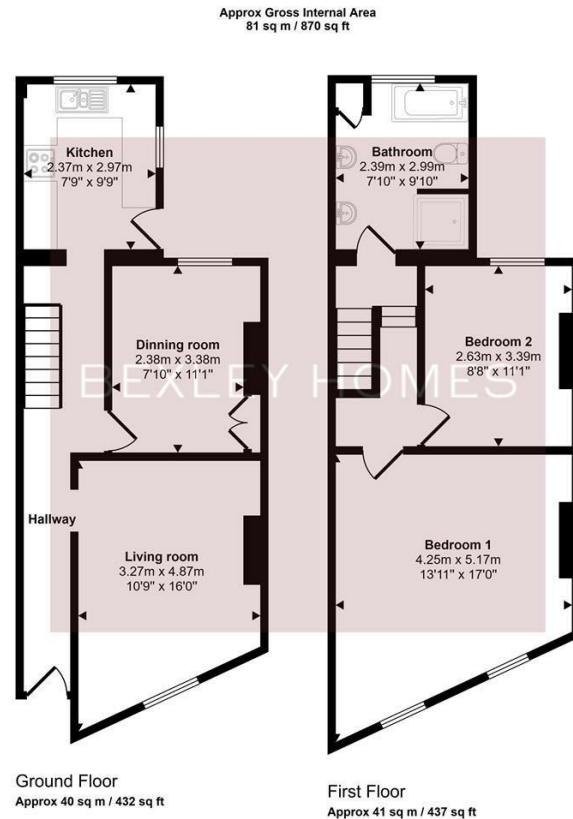

This floorplan is only for illustrative purposes and is not to scale. Measurements of rooms, doors, windows, and any items are approximate and no responsibility is taken for any error, omission or mis-statement. Icons of items such as bathroom suites are representations only and may not look like the real items. Made with Made Snappy 360.

Call us on
01322 948500

Belvedere@bexleyhomes.co.uk
www.bexleyhomes.co.uk

Council Tax Band
C

Energy Efficiency Rating		Current	Potential
<i>Very energy efficient - lower running costs</i>			
(92 plus)	A		
(81-91)	B		
(69-80)	C		
(55-68)	D		
(39-54)	E		
(21-38)	F		
(1-20)	G		
<i>Not energy efficient - higher running costs</i>			
England & Wales		EU Directive 2002/91/EC	

Agents Note: Whilst every care has been taken to prepare these particulars, they are for guidance purposes only. All measurements are approximate and are for general guidance purposes only and whilst every care has been taken to ensure their accuracy, they should not be relied upon and potential buyers are advised to recheck the measurements.

BEXLEY HOMES